

# Signaling system - PSI-MODEM-SMS-REL/6ADI/4DO/ DC - 2313520

Please be informed that the data shown in this PDF Document is generated from our Online Catalog. Please find the complete data in the user's documentation. Our General Terms of Use for Downloads are valid (<http://download.phoenixcontact.com>)



SMS remote control and signaling system for mounting on EN DIN rail. Installation built-in device as per DIN 43880. 6 analog or digital configurable inputs and 4 relay outputs. Supply voltage 24 V DC. Scope of supply: SMS relay, antenna, software, RS-232 cable.

## Product Features

- SMS status query of all inputs and outputs
- SMS remote control of outputs
- Notification via SMS on change of status at input
- Integrated phone book for up to 50 numbers
- Maximum of 5 receivers per SMS message
- Easy configuration on PC without programming knowledge
- Configuration software and programming cable supplied as standard
- Can be used worldwide
- Installation component model according to DIN 43880
- Alarm generation on voltage failure via SMS
- Password protection
- Switching of outputs for a predefined time
- RS-232 configuration interface
- GSM mobile phone network: 850, 900, 1800, and 1900 MHz



## Key commercial data

|                  |               |
|------------------|---------------|
| package_quantity | 1             |
| GTIN             | 4046356466127 |

## Technical data

### Dimensions

|        |       |
|--------|-------|
| Width  | 88 mm |
| Height | 90 mm |
| Depth  | 60 mm |

### Digital outputs

|                   |              |
|-------------------|--------------|
| Output name       | Relay output |
| Number of outputs | 4            |

# Signaling system - PSI-MODEM-SMS-REL/6ADI/4DO/ DC - 2313520

## Technical data

### Digital outputs

|                                    |                                       |
|------------------------------------|---------------------------------------|
| <b>Contact type</b>                | PDT                                   |
| <b>Contact material</b>            | AgNi (90/10) gold-plated              |
| <b>Maximum switching voltage</b>   | 250 V AC/DC                           |
| <b>Limiting continuous current</b> | 10 A (per relay)                      |
| <b>Limiting continuous current</b> | 20 A (Total current of all contacts)  |
| <b>Maximum inrush current</b>      | 15 A (20 ms)                          |
| <b>Mechanical service life</b>     | ca. 30 x 10 <sup>6</sup> Schaltspiele |

### Digital inputs

|                                   |                    |
|-----------------------------------|--------------------|
| <b>Description of the input</b>   | Digital input      |
| <b>Number of inputs</b>           | 6                  |
| <b>Switching level "0" signal</b> | ≤ 9.5 V DC         |
| <b>Switching level "1" signal</b> | ≥ 9.5 V DC         |
| <b>Description of the input</b>   | Analog input       |
| <b>Number of inputs</b>           | 6                  |
| <b>Voltage input signal</b>       | 0 V DC ... 10 V DC |
| <b>Resolution</b>                 | 10 Bit             |

### Power supply

|                                    |                     |
|------------------------------------|---------------------|
| <b>Supply voltage range</b>        | 12 V DC ... 48 V DC |
| <b>Typical current consumption</b> | < 15 mA (24 V DC)   |

### General

|                                      |  |
|--------------------------------------|--|
| <b>Electromagnetic compatibility</b> | Conformance with R&TTE directive 1999/5/EC |
| <b>Color</b>                         | white                                      |

### Radio interface

|                              |                                   |
|------------------------------|-----------------------------------|
| <b>Interface description</b> | GSM                               |
| <b>Frequency</b>             | 850 MHz (2 W (EGSM))              |
| <b>Frequency</b>             | 900 MHz (2 W (EGSM))              |
| <b>Frequency</b>             | 1800 MHz (1 W (EGSM))             |
| <b>Frequency</b>             | 1900 MHz (1 W (EGSM))             |
| <b>Antenna</b>               | 50 Ω impedance SMA antenna socket |

## classifications

### eCl@ss

|                   |          |
|-------------------|----------|
| <b>eCl@ss 4.0</b> | 27250312 |
| <b>eCl@ss 4.1</b> | 27250312 |
| <b>eCl@ss 5.0</b> | 27242208 |
| <b>eCl@ss 5.1</b> | 27242208 |
| <b>eCl@ss 6.0</b> | 27242208 |

# Signaling system - PSI-MODEM-SMS-REL/6ADI/4DO/ DC - 2313520

## classifications

### eCl@ss

|            |          |
|------------|----------|
| eCl@ss 7.0 | 27242208 |
| eCl@ss 8.0 | 27242208 |

### ETIM

|          |          |
|----------|----------|
| ETIM 2.0 | EC000310 |
| ETIM 3.0 | EC000310 |
| ETIM 4.0 | EC000310 |
| ETIM 5.0 | EC000740 |

### UNSPSC

|               |          |
|---------------|----------|
| UNSPSC 6.01   | 30211506 |
| UNSPSC 7.0901 | 39121008 |
| UNSPSC 11     | 39121008 |
| UNSPSC 12.01  | 39121008 |
| UNSPSC 13.2   | 43201553 |

## approvals

UL Listed / cUL Listed / UL Listed / cUL Listed / cULus Listed /

### Approval details

UL Listed

cUL Listed

cULus Listed

## Signaling system - PSI-MODEM-SMS-REL/6ADI/4DO/ DC - 2313520

accessories

### Antenna

PSI-GSM/UMTS-QB-ANT - 2313371



PSI-GSM/UMTS-ANT-OMNI-2-5 - 2900982



### Arrester test system

CM-KBL-RS232/USB - 2881078



### Coaxial cable

PSI-CAB-GSM/UMTS- 5M - 2900980



PSI-CAB-GSM/UMTS-10M - 2900981



# Signaling system - PSI-MODEM-SMS-REL/6ADI/4DO/ DC - 2313520

accessories

---

## Surge protection for transceiver systems

CSMA-LAMBDA/4-2.0-BS-SET - 2800491



---

## Drawings

Application drawing

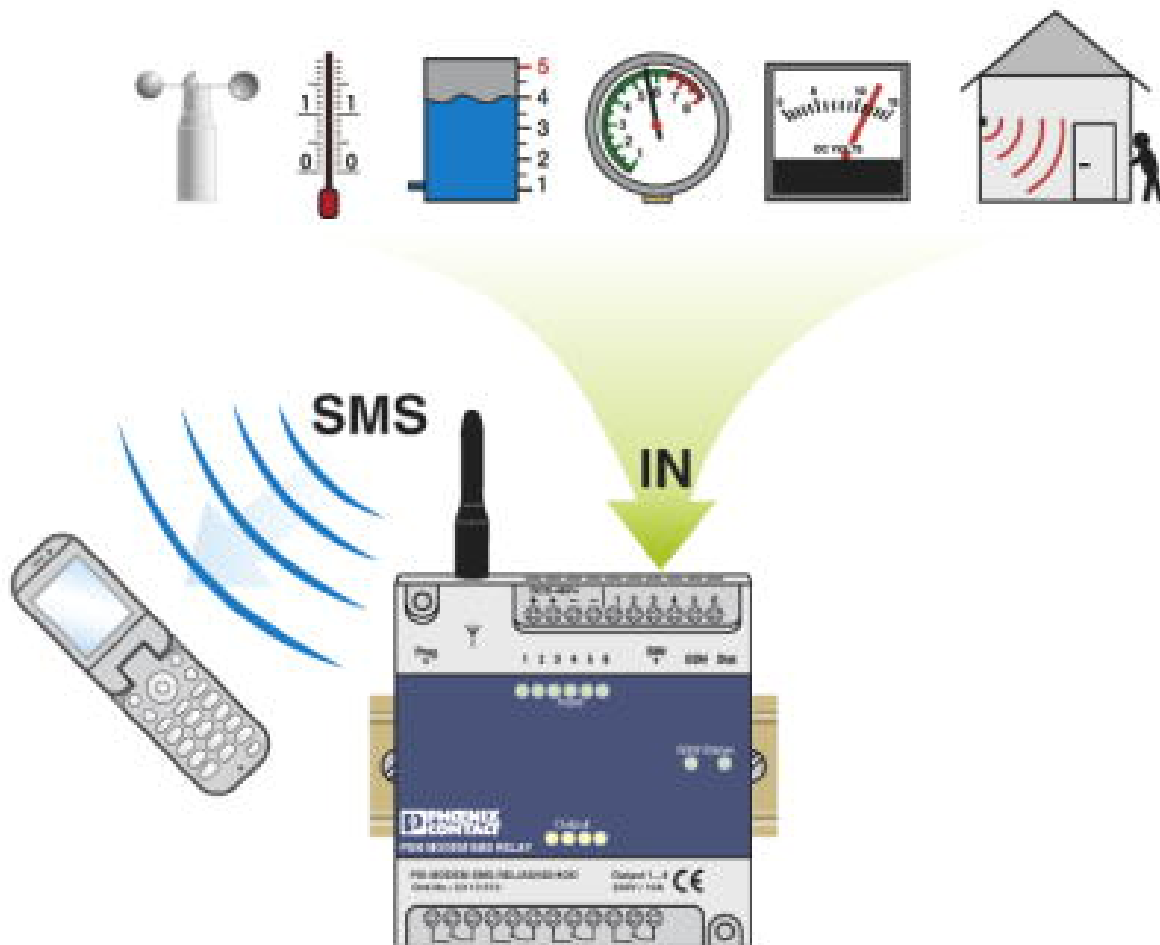

# Signaling system - PSI-MODEM-SMS-REL/6ADI/4DO/ DC - 2313520

Application drawing

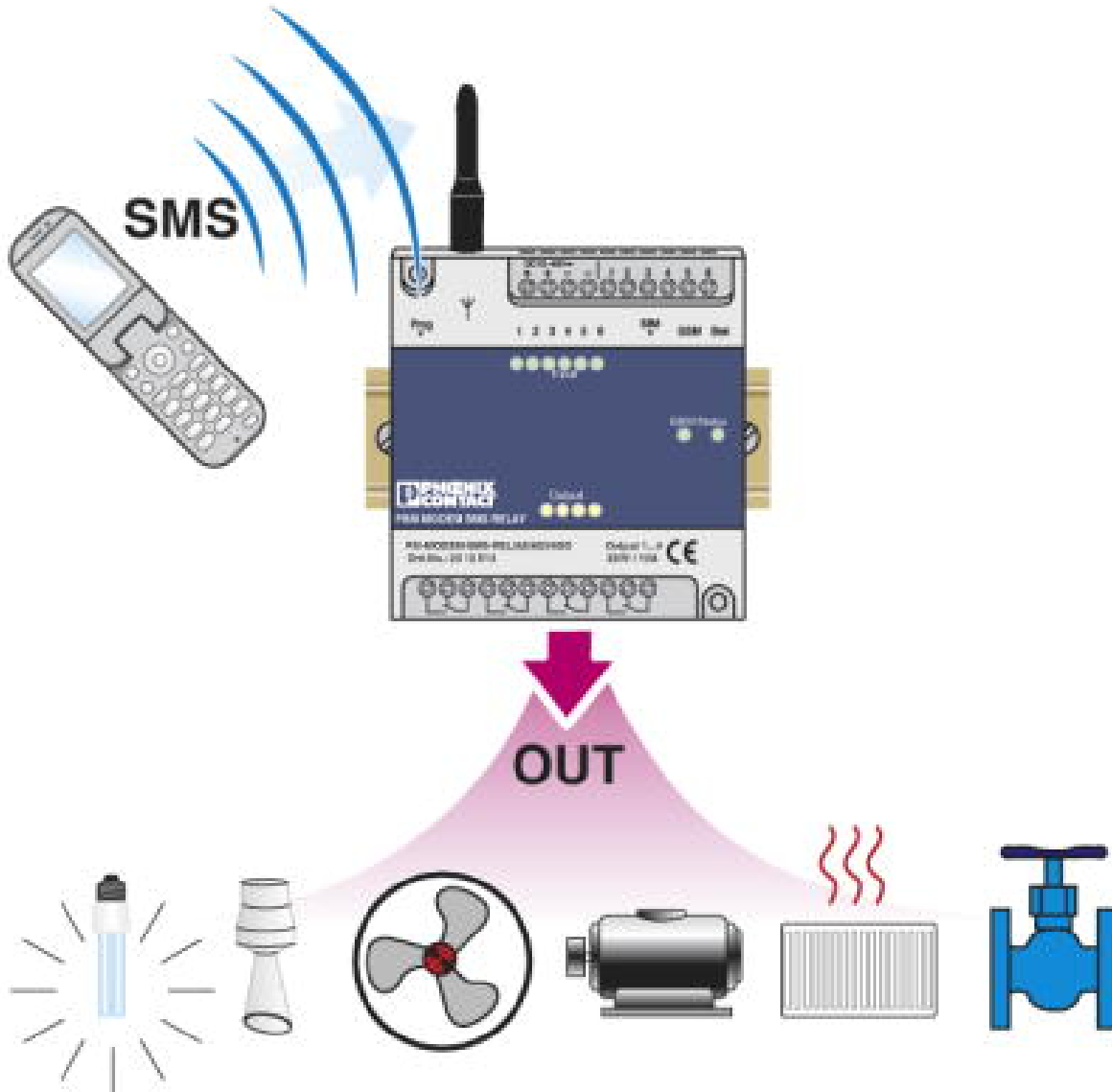

# Signaling system - PSI-MODEM-SMS-REL/6ADI/4DO/ DC - 2313520

Dimensioned drawing

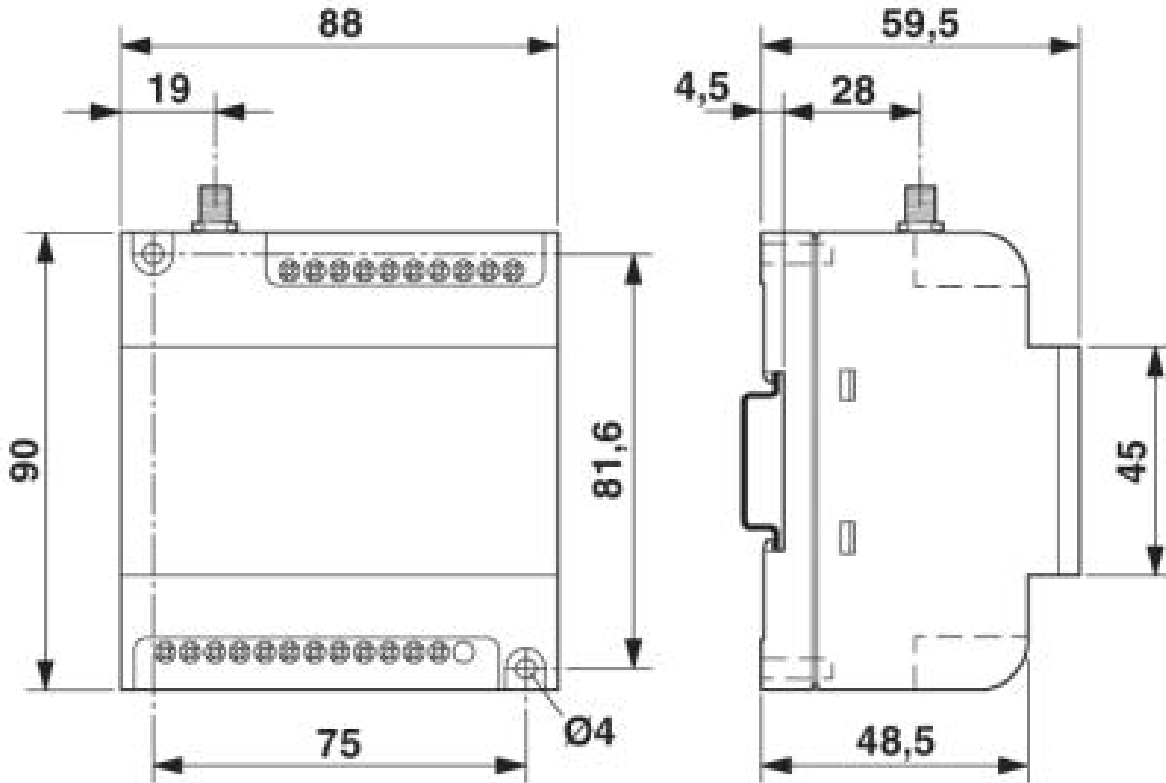

© Phoenix Contact 2014 - all rights reserved  
<http://www.phoenixcontact.com>