

Insulated enclosure

175 × 115 × 100 mm

20 A / 25 A / 32 A / 40 A / 63 A

Main/Emergency-Off Switch ■
Main Switch ■

3 ... 4 pole

IP66

Insulated polycarbonate enclosure
Cover interlock in ON position



Order code structure:

Ordering example: 4 pole Main Switch, 32A, M-padlock device:

Type - Switching programme - Mounting form

H226 - 41400 - 710M1

| Type | Rated data (IEC 60947) | | |
|------|--|--|------|
| | Operational current I _o AC-21A (A) | Operational power (at 380–440V) AC-23A (kW) AC-3 (kW) | |
| H216 | 20 | 5.5 | 3.7 |
| H220 | 25 | 7.5 | 5.5 |
| H226 | 32 | 11 | 7.5 |
| H233 | 40 | 15 | 11 |
| H263 | 63 | 22 | 18.5 |

Detailed technical data page 108.

| Switching progr. | Poles | Auxiliary contacts | |
|------------------|-------|--------------------|-----|
| | | n/o | n/c |
| 41300 | 3 | 0 | 0 |
| 41311 | 3 | 1 | 1 |
| 41320 | 3 | 2 | 0 |
| 41400 | 4 | 0 | 0 |
| 41411 | 4 | 1 | 1 |
| 41420 | 4 | 2 | 0 |

Switching diagrams and further switching programmes (3 ... 4 pole) page 95.

| Mounting form | Operator | Main/Emergency-Off Switch | Mounting form | Operator | Main Switch |
|---------------|----------|--------------------------------------|---------------|----------|--|
| 710N4 | | N-padlock device yellow/red | 710N1 | | N-padlock device black |
| 710M4 | | M-padlock device yellow/red | 710M1 | | M-padlock device black |
| 710V4 | | padlockable with V-handle yellow/red | 710V1 | | padlockable with V-handle silver/black |

Dimensions in mm:

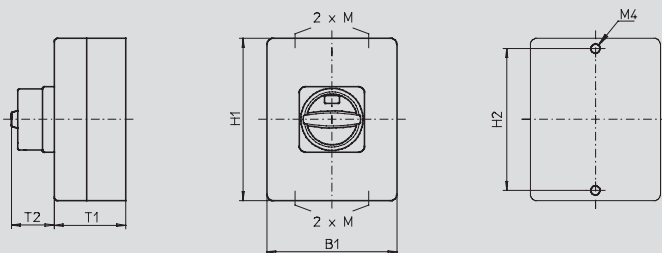

| Mounting form | H1 | B1 | T1 | T2 | 2xM | H2 |
|---------------|-----|-----|-----|----|-------|-----|
| 710N4 / 710N1 | 175 | 115 | 100 | 33 | 20/25 | 165 |
| 710M4 / 710M1 | 175 | 115 | 100 | 38 | 20/25 | 165 |
| 710V4 / 710V1 | 175 | 115 | 100 | 39 | 20/25 | 165 |